

# Installation Instructions

Stainless Steel Exposed Sliding Rail System  
Simple

It is the sole responsibility of the purchaser to provide adequate wall support to accommodate the weight of the rail system.

Please refer to the Frequently Asked Questions page included in this package before beginning installation.

## You Will Need:

Spirit Level	Metric Allen Key Set
Measuring Tape	Plastic Wedge or Wood Shims
Power Drill	provided general specification sheet(s)
8mm [5/16"]/10mm [3/8"]drill bit	Combination Wrench size 10mm [3/8"]
Phillips Screwdriver	

### Step 1:

#### Drill first hole

Locate and drill first hole

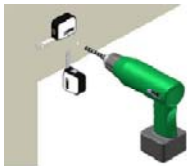

NOTE: Solid backing is required!

### Step 6:

#### Attach wheel to panel

Safely secure panel on a flat surface. Prepare the top of panel according to provided general specification sheets. Remove anti-jump from wheel assembly. Secure the wheel assembly to the panel with machine screws provided. Do not re-attach anti-jump and ensure all screws are tight.

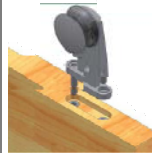

### Step 2:

#### Drill remaining mounts

"Loosely" screw on wall mounts. See step 3. Align rail horizontally using the spirit level. Use rail as drilling jig for wall drillings and pre-drill further fastening holes with 8mm drill bit. Then drill the holes for plastic anchors with 10mm drill bit.

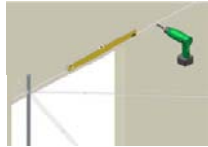

### Step 7:

#### Hanging the panel

Gently hang assembled panel onto rail. Place plastic wedges or wood shims beneath the panel to secure and ensure a 7mm (1/4") undercut. Navigate panel onto floor guide. Ensure the stops are secure and remove shims.

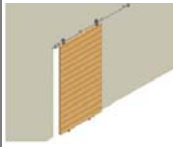

### Step 3:

#### Install stoppers to rail

Fasten door stopper on left and right end of rail to prevent the sliding door from sliding off the rail during installation.



### Step 8:

#### Re-attach Anti-Jump

Re-attach anti-jump to wheel assembly.

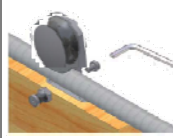

### Step 4:

#### Mount rail to wall

Fasten rail to the wall using enclosed fastening materials.



### Step 9:

#### Examine function ability

Test that the door is sliding properly. Make any necessary adjustments to stoppers and attach the handles.

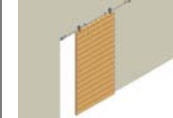

### Step 5:

#### Attach floor guide

Fasten floor guide on floor using enclosed fastening materials and in accordance to BARTELS provided general specification sheets provided. Door leaf should run parallel to wall at specific distance from wall or baseboard.



### Step 10:

#### Tighten Screws

Be sure to go back and tighten all screws.

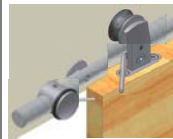

Simple System is suitable for panels with a thickness greater than 20mm [13/16"]

**StainlessSteelStuff**